

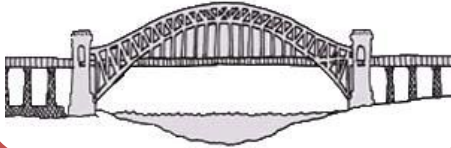

An Arch Bridge can be built using: wood, stone, steel or concrete

BRIDGE TYPE Arch



A Cablestayed Bridge is usually built using: steel cables and concrete

BRIDGE TYPE Cablestayed



A Cantilever Bridge is usually built using: steel beams and concrete

BRIDGE TYPE Cantilever

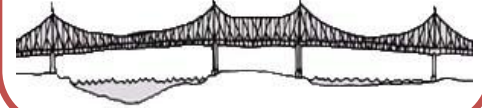

A Girder Bridge is usually built using: steel beams and reinforced concrete

BRIDGE TYPE Girder

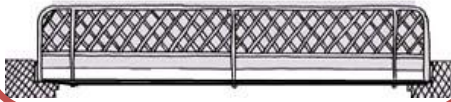

A Suspension Bridge is usually built using: steel cables and reinforced concrete

BRIDGE TYPE Suspension

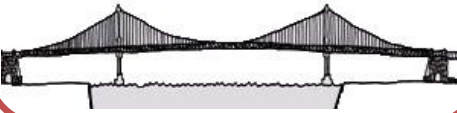

A Truss Bridge is usually built using: steel or iron beams

BRIDGE TYPE Truss

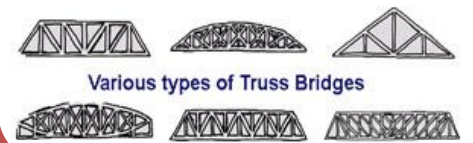

Various types of Truss Bridges



A Vertical Lift Bridge rises from the pillar supports to allow passage

BRIDGE TYPE Vertical Lift

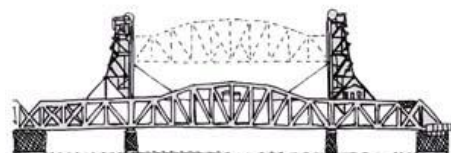

A Bascule Bridge is designed to lift vertically at one end at a pivot point to allow passage

BRIDGE TYPE Bascule

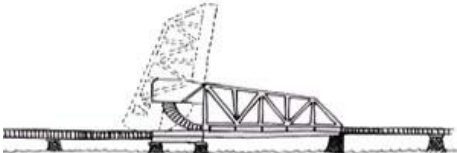

A Swing Bridge pivots on the center pillar to allow passage

BRIDGE TYPE Swing

